

MARKET AT CROSSINGS (PHASE ONE)

LETHBRIDGE, ALBERTA, CANADA

062615 | 1501

PROJECT DESCRIPTION

Project Type:
Commercial Retail / Hospitality

Client:
Royop (Crossings 1) Development Corporation
Budget (CAD\$):
Withheld

Size / Program:
Multi-Building Site Development

Building Design / Engineering:
010110 | Architecture + Urbanism with Gibbs Gage Architects, Ground 3, TRL, HidiRae, Stantec

Services:
Construction Administration

General Contractor:
Elan Construction Ltd.

Project Date / Status:
2015+ / Completed July, 2016

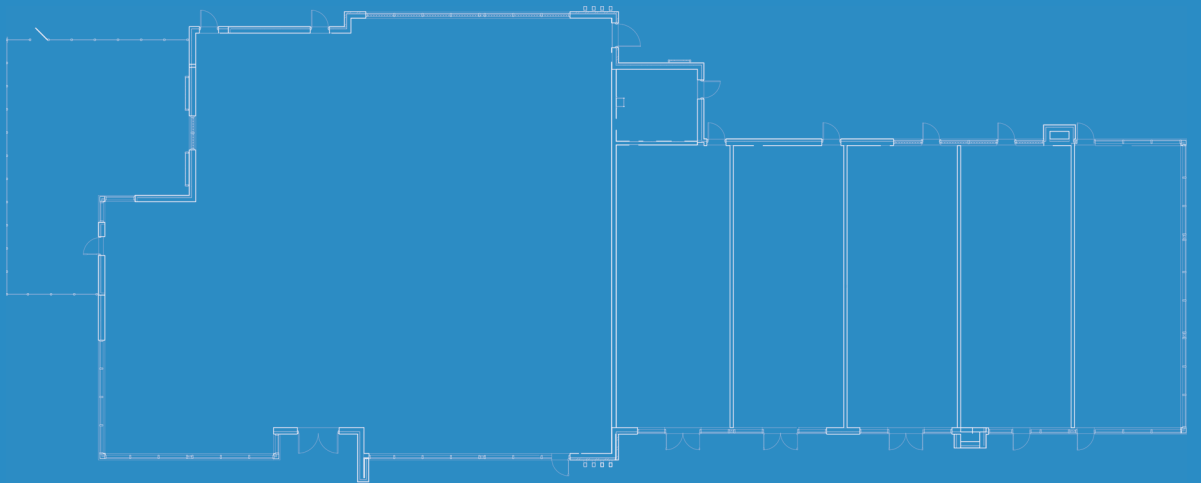

Main Floor Plan - Building D

The development utilizes unique landscape features to connect buildings and the public realm and create meaningful social community places.

PROJECT SUMMARY

The Market at Crossings is a multi-phase commercial retail, office and hospitality development located in the new Crossings area of west Lethbridge.

The first phase includes development with a strong pedestrian emphasis layering walkable connections to nearby residential communities, public parks and new facilities such as the Crossings Branch Library, two high schools and nearly completed new city recreational facilities and planned aquatic rec centre. The development also relies on unique landscape features and patio spaces to connect the public realm and create meaningful community and social integration.

Anchor tenants in this phase include Boston Pizza, Subway, Rice King, Tim Horton's and Original Joe's restaurants along with Rexall pharmacy and Loblaws 'No Frills' brand grocer and fuel station.

Situated in Lethbridge, One One Ten has been primarily responsible for all construction administration and coordination of the professional design team as a consultant to Gibbs Gage Architects of Calgary partnered with the developer Royop Development and Elan Construction to deliver the project; all who have been exceptional team collaborators in bringing the project to fruition.



One of Several Feature Glass Gabion Walls

Spencer Court



MARKET AT CROSSINGS (PHASE ONE)

LETHBRIDGE, ALBERTA, CANADA



Site + Building Photographs, Substantial Completion Stage - May 2016